

CORRUGATED SIDEWALL ROLL-IN REFRIGERATOR RACKS 208 SERIES (FOR 18" X 26" PANS)

FEATURES AND BENEFITS:

- Durable rack specifically designed to fit roll-in or pass through refrigerators, freezers, and warming cabinets; eliminates unnecessary product handling while maintaining proper temperature levels. Holds 18" x 26" pans.
- Fully welded framework of structural aluminum extrusions for rigidity and durability.
- Constructed of non-corrosive, Hi-Tensil aluminum for strength.
- Corrugated sidewalls securely hold 18" x 26" pans on 1-1/2" centers without tipping. Provides added strength.
- Inboard heavy duty 5" swivel casters, two with brakes. Wheel placement permits easy "in-and-out" of roll-ins.
- Two styles available; Custom (C) or Deluxe (D). Deluxe includes perimeter bumper and enclosed base.



208-1835C



ACCESSORIES and OPTIONS (Available at extra cost):

- Pan Stop
- Corner Bumpers
- Vertical Bumpers
- Various Caster Options

See page G-36 for accessory details.



208 Roll-In Series (18" x 26" pans)

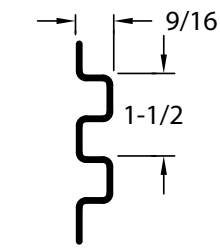

DETAIL OF
PAN SLIDE

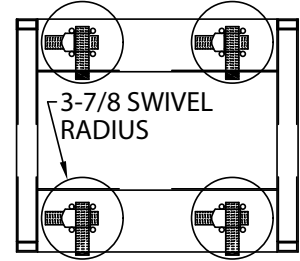
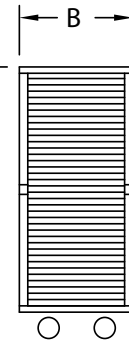
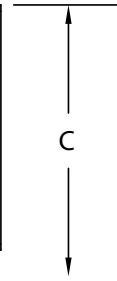
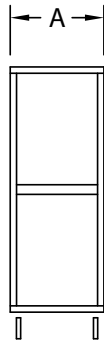
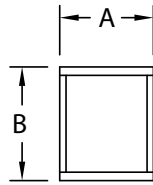

INBOARD CASTER PLACEMENT

CUSTOM ("C")

CRES COR MODEL NO.	PAN			DIM "A"	DIM "B"	DIM "C"	INSIDE DIMENSIONS				WEIGHT ACT.
	CAP	SIZE		WIDTH	DEPTH	HEIGHT	WIDTH	DEPTH	HEIGHT		
208-1835-C	35	18 x 26	IN	20-11/16	25-1/8	64-1/2	18-1/8	24-3/8	55-15/16	LBS	65
		460 x 660	MM	525	640	1640	460	620	1425	KG	29

DELUXE ("D")

CRES COR MODEL NO.	PAN			DIM "A"	DIM "B"	DIM "C"	INSIDE DIMENSIONS				WEIGHT ACT.
	CAP	SIZE		WIDTH	DEPTH	HEIGHT	WIDTH	DEPTH	HEIGHT		
208-1835-D	35	18 x 26	IN	22-9/16	27	64-1/2	18-1/8	24-3/8	55-15/16	LBS	70
		460 x 660	MM	575	690	1640	460	620	1425	KG	32

Note: Send sample pan or tray with order when using any that are not 18" x 26" pans with heavy beaded edges.

ALL ALUMINUM CONSTRUCTION IS RIVETED, WELDED AND FINISHED.



Gold indicates our Best Rack with the best warranty in the industry.
3-Year Parts / 1-Year Labor with lifetime guarantee against rust & corrosion

RACK:

- Posts: Extruded channels, 1-1/16 x 2 x .125.
- Top and bottom: Extruded channels, 1-1/16 x 2-3/8 x .188; welded to posts.
- Tie rods (2): 5/16 dia. steel rods enclosed in aluminum tubing; fastened to posts.
- Sides: .063 aluminum corrugations riveted to posts.
- Bolsters: Formed .190 aluminum; welded to posts, casters attached.
- Casters: 5" dia., swivel, modulus tires, 1-1/4 wide, load cap. 250 lbs. each, temp. range -45°/+180°F. Delrin bearings. Two casters equipped with brakes.

DELUXE ("D") MODELS:

- Base plate: One piece .063 aluminum.
- Bumper: 1" wide gray rubber, perimeter type.

PAN SLIDES:

- Corrugations act as pan slides on 1-1/2" centers.

SHORT FORM SPECIFICATIONS

Cres Cor Roll-In Refrigerator Rack Model 208-1835- (C) or (D). Extruded aluminum welded construction. Tie rods (2) applied at front and rear. No-tip corrugated sides for (35) 18" x 26" pans on 1-1/2" centers. Inboard 5" swivel modulus casters, Delrin bearings. Load capacity 250 lbs. each, temperature -45° to +180°F.

Custom Model (C)

Deluxe Model (D) has .063 aluminum base plate; perimeter bumper.

3-Year Parts / 1-Year Labor warranty. Lifetime guarantee against rust & corrosion. Provide the following accessories: _____ . NSF listed.



5925 Heisley Road • Mentor, OH 44060-1833
Phone: 877/CRESCOR • Fax: 440/350-7267
www.crescor.com

© Crescent Metal Products, Inc. 2011 All rights reserved.

In line with its policy to continually improve its products, CRES COR reserves the right to change materials and specifications without notice.

Litho in U.S.A.